

Tel: 966 12 684 8046  
 966 12 684 8959  
 Fax: 966 12 640 5622  
 AFS OEJDYKYX  
<http://www.sans.com.sa>  
 E-mail: [aim@sans.com.sa](mailto:aim@sans.com.sa)

**KINGDOM OF SAUDI ARABIA**  
 GENERAL AUTHORITY OF CIVIL AVIATION  
 SAUDI AIR NAVIGATION SERVICES  
 AERONAUTICAL INFORMATION MANAGEMENT  
 P. O. BOX 929, JEDDAH - 21421

**AIP  
 SUP**  
**AIP SUP 13/26**  
 12 MAR 2026

## Arresting System Upgrade Project of RWY 25 at TAIF AIRPORT

### 1 .INTRODUCTION

1. This AIP Supplement aims to notify operators regarding the Arresting System in RWY 25.
2. The working area related is provided in attachment.
3. This AIP Supplement will remain in force until the end of scope of work and Runway 25 activation.

### 2 .PURPOSE

1. Inform pilots and operators about the duration and timeline of working Area and closure of Runway 25 in Taif Airport.
2. Disseminate the temporary operating procedures.
3. Detailed the affected areas in the airport.
4. Detailed the safety control measures.

### 3 .PHASES OF WORK

RWY 25 Arresting System Upgrade:

1. Closure of Runway 07/25.
2. Paint (X) mark on the pavement as per the standard sizes on Runway 07/25.
3. Field survey work.
4. Old system removal.
5. Excavation works.
6. Cable laying.
7. Backfilling and installation the new system.

### 4 .TIMELINE, OPERATIONAL PROCEDURES AND SAFETY MEASURES

Area	Start-End Dates	Construction Activities	Operational Procedure	Safety measures
RWY 25	From 12 MAR 2026 TO UFN.	1. PAK 14 barrier control. 2. Cable laying. 3. Backfilling and installation of-manholes. 4. Civil works of the new system. 5. Removal of the current system. 6. Installation, operation, and testing.	-	1. Apply Safety measures during drilling. 2. Transporting equipment. 3. Disconnecting old equipment. 4. Documentation of work.

## 5 .PRECAUTIONS

1. During all phases of the project, pilots must be careful of construction area.
2. During construction pilots should pay attention when taxiing near the work area.
3. Pilots must carefully check AIP amendments and NOTAMS for any updates.
4. Presence of construction workers, materials, and equipment in work area.

## 6 .Obstacles during work at RWY 25

Location	LATITUDE	LONGITUDE	Height AGL	Height AGL	Height AMSL	Height AMSL	Work Start	Work Finish	Duration (Days)
			Meter	Feet	Meter	Feet			
1	21° 28 43.31 N	40°31 30.83 E	0.3302	1.0833	1,472.75	4,831.85	12/03/2026	UFN	-
2	21° 28 41.32 N	40°31 31.41 E	0.3302	1.0833	1,472.75	4,831.85	12/03/2026	UFN	-
3	21° 29 07.85 N	40°33 05.87 E	0.3302	1.0833	1,448.87	4,753.5	12/03/2026	UFN	-
4	21° 29 05.84 N	40°33 06.44 E	0.3302	1.0833	1,448.87	4,753.5	12/03/2026	UFN	-

## 7 .INQUIRIES

For any inquiries on the airside development project at Taif Airport, please contact:

<b>Name:</b> Fahad A. Alosami <b>Function:</b> Taif International Airport director <b>Email:</b> <a href="mailto:falosaimi@cluster2airports.sa">falosaimi@cluster2airports.sa</a>	<b>Name:</b> Mashari A. Alhakami <b>Function:</b> Operation supervisor <b>Email:</b> <a href="mailto:mealhakami@cluster2airports.sa">mealhakami@cluster2airports.sa</a>
---	---

-END-

**AERODROME CHART - ICAO** 21°29'00"N  
040°32'40"E **ELEV 4848**

TWR 118.7 237.6  
SMC 121.9 335.3  
ATIS 127.05

**TAIF / Taif International**

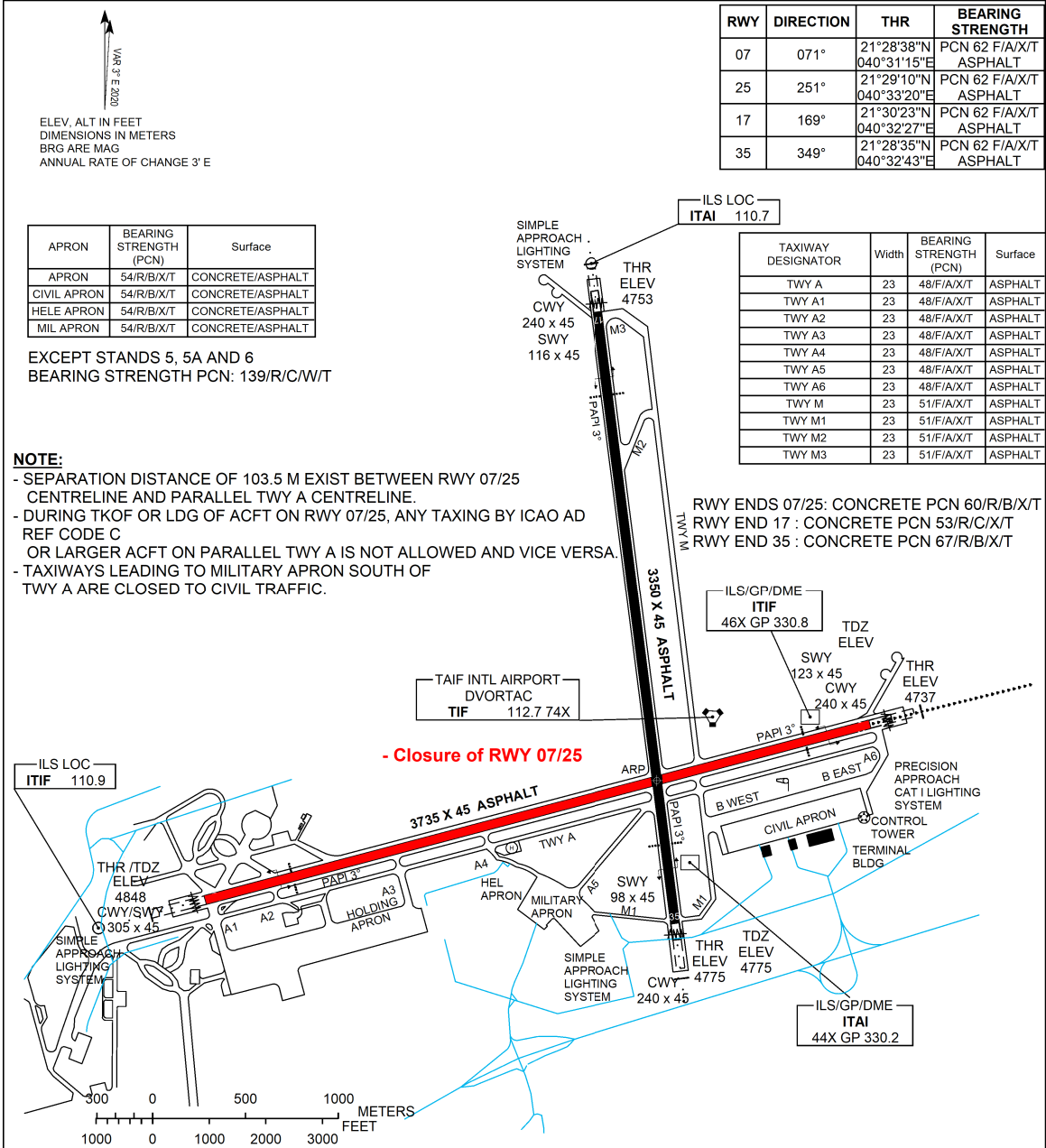

CHANGES: Display of CWY

**NOTES**

TAIF INTERNATIONAL AIRPORT (OETF) MAY BE USED AS AN ALTERNATE FOR B747-8 AIRCRAFT SUBJECT TO THE FOLLOWING LIMITATIONS.

1. B747-800 AIRCRAFT ALL OPERATING WEIGHT DOES NOT EXCEED 350 TONS.
2. B747-800 AIRCRAFT SHALL USE RWY 17/35 AND PARALLEL TAXIWAY M & B.
3. PARKING PAD NO. 11 ON CIVIL APRON AT NOSE-IN POSITION IS THE ONLY AUTHORIZED PARKING FOR 747-8 AND PILOT MUST CONTACT TOWER FOR PARKING INSTRUCTIONS.

LEGEND	
RWY VISUAL RANGE (RVR)	
WIND DIRECTION INDICATOR	
HELIPAD	
SERVICE ROAD	
BAK-14 ARRESTER GEAR	
BARRIER NET	
CLOSED	